

MONTECARLO

Home Office



ITALIA 

MONTECARLO

Home office









*The “Montecarlo Home Office” enriches and completes
the “Montecarlo” Collection.*







High quality office furniture, beautiful and functional pieces developed and produced with close attention to all details.









“Montecarlo Home Office” offers various composition possibilities to create an environment functional to your activities and needs.







MONTECARLO HOME OFFICE IN KOTÒ HIGH GLOSS



CREDENZA HUTCH W. 180 PJMN0750
With doors and wireway

inch	W 71"	D 15"	H 54"
cm	L 179,6	P 38,8	H 137
Crts	4	kg 99	m ³ 0,37



FILE CABINET HUTCH W. 90 PJMN0740
With doors and wireway

inch	W 35"	D 15"	H 54"
cm	L 90	P 37,6	H 137
Crts	2	kg 46	m ³ 0,15



LIBRARY BOOKCASE PJMN0770
(RIGHT or LEFT) With doors and shelves

inch	W 39"	D 15"	H 84"
cm	L 100	P 38,8	H 213,4
Crts	3	kg 100	m ³ 0,39

ADDITIONAL SHELF KJMN773

inch	W 18"	D 13"	H 1"
cm	L 46	P 33,5	H 2,5
Crts	1	kg 6	m ³ 0,42

LIGHT SYSTEM KJMN775

For Credenza hutch and File cabinet hutch

inch	W 32"	D 4"	H 4"
cm	L 80	P 10	H 10
Crts	1	kg 2	m ³ 0,67



CREDENZA W. 180 KJMN700

With 2 doors and 2 large file drawers
featuring adjustable feet levellers

inch	W 71"	D 21"	H 30"
cm	L 179,6	P 52,7	H 76,5
Crts	1	kg 115	m ³ 0,89



FILE CABINET W. 90 RIGHT KJMN710
LEFT KJMN715

With 2 large file drawers
featuring adjustable feet levellers

inch	W 36"	D 21"	H 30"
cm	L 89,8	P 52,7	H 76,5
Crts	1	kg 70	m ³ 0,46



PEDESTAL WITH WHEELIES KJMN720

With 1 drawer and 1 big file drawer

inch	W 18"	D 18"	H 24"
cm	L 46,7	P 46,2	H 60
Crts	1	kg 30	m ³ 0,18



PEDESTAL WITH FEET KJMN725

With 1 drawer and 1 big file drawer
featuring adjustable feet levellers

inch	W 18"	D 18"	H 23"
cm	L 46,7	P 46,2	H 57,8
Crts	1	kg 28	m ³ 0,18



DESK W. 180 PJMN0780

With 2 wireways
featuring adjustable feet levellers

inch	W 71"	D 34"	H 30"
cm	L 180	P 86	H 76
Crts	2	kg 85	m ³ 0,25



DESK W. 167 KJMN781

With 2 wireways
featuring adjustable feet levellers

inch	W 66"	D 30"	H 30"
cm	L 167,5	P 76	H 76
Crts	1	kg 77	m ³ 0,2



DESK W. 120 KJMN783

featuring adjustable feet levellers

inch	W 47"	D 22"	H 30"
cm	L 120	P 55	H 76
Crts	1	kg 48	m ³ 0,143



RETURN DESK W. 120 KJMN784

featuring adjustable feet levellers

inch	W 47"	D 22"	H 30"
cm	L 120	P 55	H 76
Crts	1	kg 42	m ³ 0,143

ATTENTION FOR W. 180/71" DESK:
When ordering the desk drawer / keyboard holder only (without the 2 lateral front panels) the drawer can be positioned centrally or laterally (to the left or to the right).

ATTENTION FOR W. 167/66" DESK:
The desk drawer / keyboard holder can be positioned centrally or laterally (to the left or to the right).

ATTENTION FOR W. 120/48" DESK / RETURN DESK:
The desk drawer can only be positioned centrally.

1 FLO® CHAIR FLO***
With chromed structure,
seat and back in black or white leatherette
inch W 23" D 21" H 34"
cm L 58 P 54 H 85,5
Crts 1 kg 15 m³ 0,160



COMPLETE DESK DRAWER / KEYBOARD HOLDER KJMN789
with 2 lateral panels (only for desk W. 180/71")

inch	W 67"	D 17"	H 3"
cm	L 171	P 42,1	H 7,5
Crts	1	kg 6	m ³ 0,04



CENTRAL DESK DRAWER / KEYBOARD HOLDER KJMN788

inch	W 26"	D 17"	H 3"
cm	L 67	P 42	H 7,5
Crts	1	kg 5	m ³ 0,04



COMPOSITION EXAMPLES:

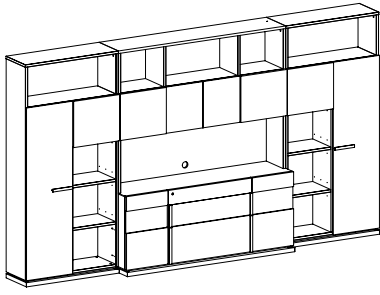

LIBRARY COMPOSITION 1 PJMN0800
 inch W 150" D 21" H 84"
 cm L 379,6 P 52,7 H 213,4
 Crts 11 kg 414 m³ 2,048

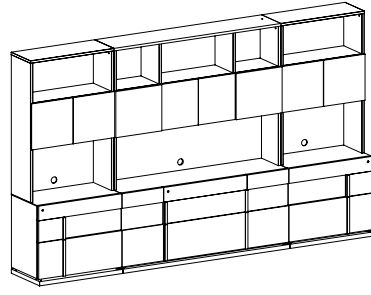

LIBRARY COMPOSITION 2 PJMN0801
 inch W 142" D 21" H 84"
 cm L 359,6 P 52,7 H 213,4
 Crts 11 kg 446 m³ 2,482

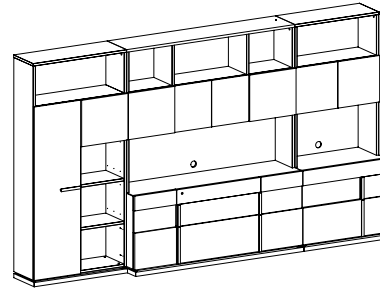

LIBRARY COMPOSITION 3 PJMN0802
 inch W 146" D 21" H 84"
 cm L 369,6 P 52,7 H 213,4
 Crts 11 kg 430 m³ 2,265

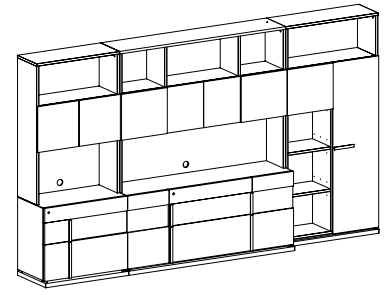

LIBRARY COMPOSITION 4 PJMN0803
 inch W 146" D 21" H 84"
 cm L 369,6 P 52,7 H 213,4
 Crts 11 kg 430 m³ 2,265

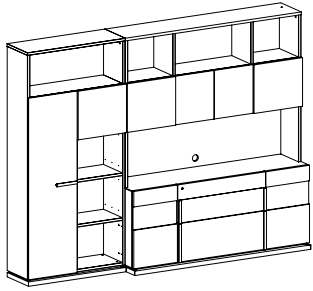

LIBRARY COMPOSITION 5 PJMN0804
 inch W 110" D 21" H 84"
 cm L 279,6 P 52,7 H 213,4
 Crts 8 kg 314 m³ 1,655

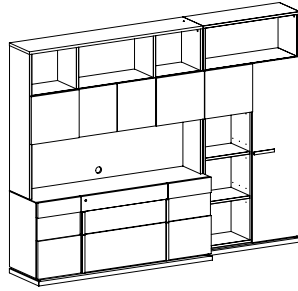

LIBRARY COMPOSITION 6 PJMN0805
 inch W 110" D 21" H 84"
 cm L 279,6 P 52,7 H 213,4
 Crts 8 kg 314 m³ 1,655

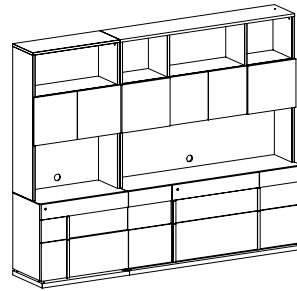

LIBRARY COMPOSITION 7 PJMN0806
 inch W 106" D 21" H 84"
 cm L 269,6 P 52,7 H 213,4
 Crts 8 kg 330 m³ 1,872

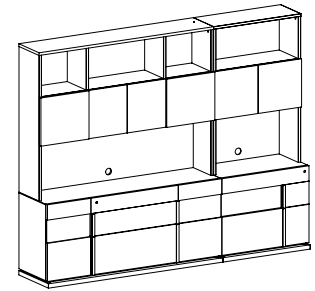

LIBRARY COMPOSITION 8 PJMN0807
 inch W 106" D 21" H 84"
 cm L 269,6 P 52,7 H 213,4
 Crts 8 kg 330 m³ 1,872

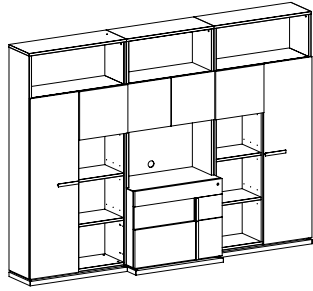

LIBRARY COMPOSITION 9 PJMN0808
 inch W 114" D 21" H 84"
 cm L 290 P 52,7 H 213,4
 Crts 9 kg 316 m³ 1,396

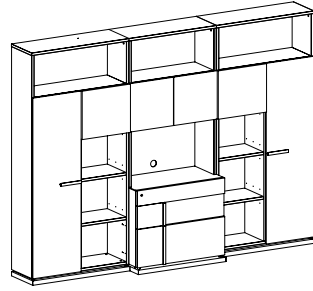

LIBRARY COMPOSITION 10 PJMN0809
 inch W 114" D 21" H 84"
 cm L 290 P 52,7 H 213,4
 Crts 9 kg 316 m³ 1,396

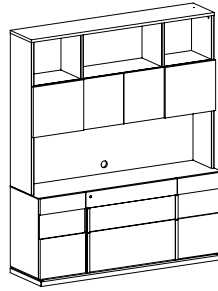

LIBRARY COMPOSITION 11 PJMN0810
 inch W 71" D 21" H 84"
 cm L 179,6 P 52,7 H 213,4
 Crts 5 kg 214 m³ 1,262

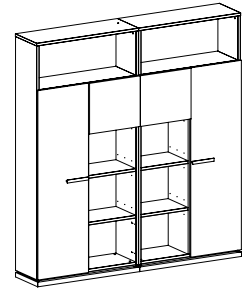

LIBRARY COMPOSITION 12 PJMN0811
 inch W 79" D 21" H 84"
 cm L 200 P 38,8 H 213,4
 Crts 6 kg 200 m³ 0,786

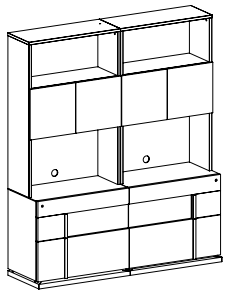

LIBRARY COMPOSITION 13 PJMN0812
 inch W 71" D 21" H 84"
 cm L 180 P 52,7 H 213,4
 Crts 6 kg 232 m³ 1,22

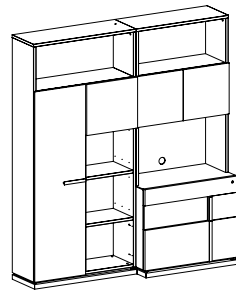

LIBRARY COMPOSITION 14 PJMN0813
 inch W 75" D 21" H 84"
 cm L 190 P 52,7 H 213,4
 Crts 6 kg 216 m³ 1,003

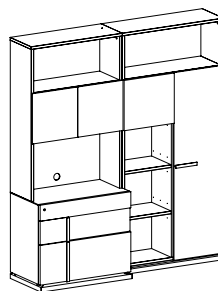

LIBRARY COMPOSITION 15 PJMN0814
 inch W 75" D 21" H 84"
 cm L 190 P 52,7 H 213,4
 Crts 6 kg 216 m³ 1,003

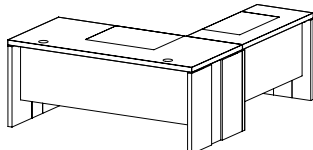

DESK COMPOSITION 1 PJMN0816
 Desk + Return desk
 inch W 71" D 81" H 30"
 cm L 180 P 206 H 76
 Crts 3 kg 127 m³ 0,393

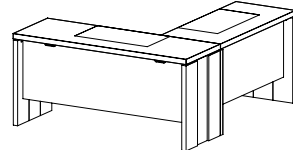

DESK COMPOSITION 2 PJMN0817
 Desk + Return desk
 inch W 66" D 71" H 30"
 cm L 167,5 P 175 H 76
 Crts 2 kg 94 m³ 0,285

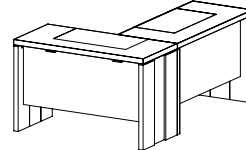

DESK COMPOSITION 3 PJMN0818
 Desk + Return desk
 inch W 47" D 71" H 30"
 cm L 120 P 175 H 76
 Crts 2 kg 90 m³ 0,286

MONTECARLO
Home Office

design
 c.r.s. Alf

photo
 STEP

selection
 Fitolito Maistri

print
 OGM



A.L.F.UNO S.P.A. is certified by the **ISO 9001:2008**.

Our furniture finishes are mainly UV-based. All our furniture board is within the E1 norm for formaldehyde emission. By using UV-based finish the formaldehyde is sealed within the furniture board keeping emissions to an absolute minimum.

ATTENTION: PRODUCT APPEARANCE, SIZE, AND/OR MATERIALS MAY BE SUBJECT TO CHANGE WITHOUT NOTICE

CANADA & USA NORTH-EAST COAST
TEL (416) 663-2223 - FAX (416) 663-2594
E-MAIL: alf@rosnerinternational.com

CENTRAL AMERICA - CARIBBEAN ISLANDS
TEL (787) 786-9705 - FAX (787) 785-9835
E-MAIL: alvin@arodz.net

LOUISIANA-OKLAHOMA-TEXAS
TEL (405) 204-4737
E-MAIL: parke9094@att.net

COLORADO-NEW MEXICO-UTAH
E-MAIL: alf@alf.it

FLORIDA
TEL (561) 212-5676 - FAX (561) 997-9169
E-MAIL: hollister@bellsouth.net

MID-WEST/SOUTH-EAST (EXCLUDING FLORIDA)
TEL (310) 636-1199 - FAX (310) 636-4433
E-MAIL: wrw@whitehalldesigns.com

U.S.A. : HIGH POINT SHOWROOM
(OPEN ONLY DURING FURNITURE MARKET DATES)
TEL (336) 889-9027 - FAX (336) 889-9079

WESTERN U.S.A.-HAWAII
TEL (949) 374.2900 - FAX (949) 364-3822
E-MAIL: alfwesternusa@aol.com

AUSTRALIA & NEW ZEALAND
TEL (08) 9314 3999 - FAX (08) 9314 3777
E-MAIL: ross@merlino.com.au

MEXICO
TEL +39 3401596793 - FAX +39 0438997246
E-MAIL: giulio.botteon@italfurniture.it

AUSTRIA
E-MAIL: alf@alf.it

GERMANY
TEL 0049 2536343450 - FAX 0049 2536343456
E-MAIL: info@magenta-vertrieb.de

SWITZERLAND
TEL 0041 523661277
TEL 0041 764174344 E-MAIL: marcopetix@gmx.ch
TEL 0041 794048941 E-MAIL: spetix@gmx.ch

BELGIQUE
TEL 0032497526746 - FAX 0032497526746
E-MAIL: stephane.porignon@telenet.be

DENMARK
TEL +45 20475875
E-MAIL: lehri@mail.dk

EAST EUROPE
TEL +39 3484064921
E-MAIL: caputomaiuro@libero.it
HUNGARY: johns@johns.hu
CZECH-SLOVACK: infinity.prague@volny.cz

U.K.
TEL +44 1565631077 - FAX +44 1565621436
E-MAIL: jim@3dpartnership.com
andrew@3dpartnership.com - jt@3dpartnership.com

FRANCE - BRETAGNE - NORMANDIE - CENTRE
TEL 0033608423974
E-MAIL: contact@jmcsarl.fr

FRANCE - EST
TEL 0033615436985
E-MAIL: ch.vicrin@wanadoo.fr

FRANCE - SUD-EST
TEL 33651330596 - FAX 33958730003
E-MAIL: albouy@sanitairedfisision.fr

FRANCE - ILE DE FRANCE
TEL 0033609810991
E-MAIL: catherinepouette@wanadoo.fr

FRANCE - NORD
TEL 0033660816585
E-MAIL: treuil.pa@wanadoo.fr

FRANCE - SUD-OUEST
TEL 0033686088876 - FAX 0033553289387
E-MAIL: fabien.lherbette@hotmail.fr

FRANCE - RHONE/ALPES
TEL 0033689923725 - FAX 0033466777294
E-MAIL: frederic.ac@orange.fr

HELLAS-CYPRUS
TEL +39 0434 77199 - FAX +39 0434 779591
E-MAIL: info@ofsolution.it

INDIA-SRI LANKA
TEL +91 8041285290 - 91 9845636644
E-MAIL: keith@kreb.in

ALF GROUP MIDDLE-EAST REP. OFFICE
TEL +961 4718160 - FAX +961 4718159
E-MAIL: info@alfme.com

POLAND
TEL +48 618175994 - FAX +48 616429218
E-MAIL: karina@qualitaitaliana.pl

CSI E PAESI BALTICI
TEL +7-812-3322934 - FAX +7-812-3322934
E-MAIL: office.spb@alf.it

SOUTH AFRICA
TEL +27 823225215 - FAX +27 865018307
E-MAIL: cliint@furntec.co.za

SPAIN - ANDALUCIA Y EXTREMADURA
TEL +34 958818744 - FAX +34 958302251
E-MAIL: info@javiercastellon.com

SPAIN - ARAGÓN, SORIA, LA RIOJA, NAVARRA Y PAIS VASCO
TEL +34 976227321 - FAX +34 976227321
E-MAIL: repres_cramon@yahoo.es

SPAIN - ASTURIAS Y CANTABRIA
TEL +34 609 803 346 - FAX +34 985 894 580
E-MAIL: gelquintueles@yahoo.es

SPAIN - BARCELONA
TEL +34 629 29 18 77
E-MAIL: comercialperlopez@gmail.com

SPAIN - CASTILLA Y LEON
TEL +34983541003 - FAX +34983541003
E-MAIL: evaristorg@gmail.com

SPAIN - CATALUNYA Y ANDORRA
TEL +34 935531590 - FAX +34 935531590
E-MAIL: albert-miro-mauri@hotmail.com

SPAIN - CATALUNYA Y ANDORRA
TEL +34 93 718 37 97 - FAX +34 93 718 37 97
E-MAIL: pepaage@hotmail.com

SPAIN - MALLORCA, MENORCA, IBIZA, FORMENTERA
TEL +34971434088 - FAX +34971434088
E-MAIL: l.bonnin@cgac.es

SPAIN - VALENCIA, MURCIA Y CASTILLA LA MANCHA
TEL +34 607 210 185
E-MAIL: joseluis@nexus-ijh.com

TURKEY
TEL +90 3128475080 - FAX +90 3128475280
E-MAIL: casa@casa.com.tr



A.L.F. UNO S.P.A.

VIA S. PIO X, 17 31018 FRANCONIGO DI GAIARINE (TV) ITALY

TEL. +39-0438 997 111 FAX +39-0438 997 246

alf@alf.it www.alfitalia.com